

# WIRING INSTRUCTIONS

TITLE

**CIRCULAR SAW**

BULLETIN

**MILWAUKEE ELECTRIC TOOL CORP. 13135 WEST LISBON RD. BROOKFIELD, WIS.**

DATE  
Apr. '98

**58-01-1260**

NOTE: Switch terminals are not to be bent more than 45°. Crimp faces away from switch.

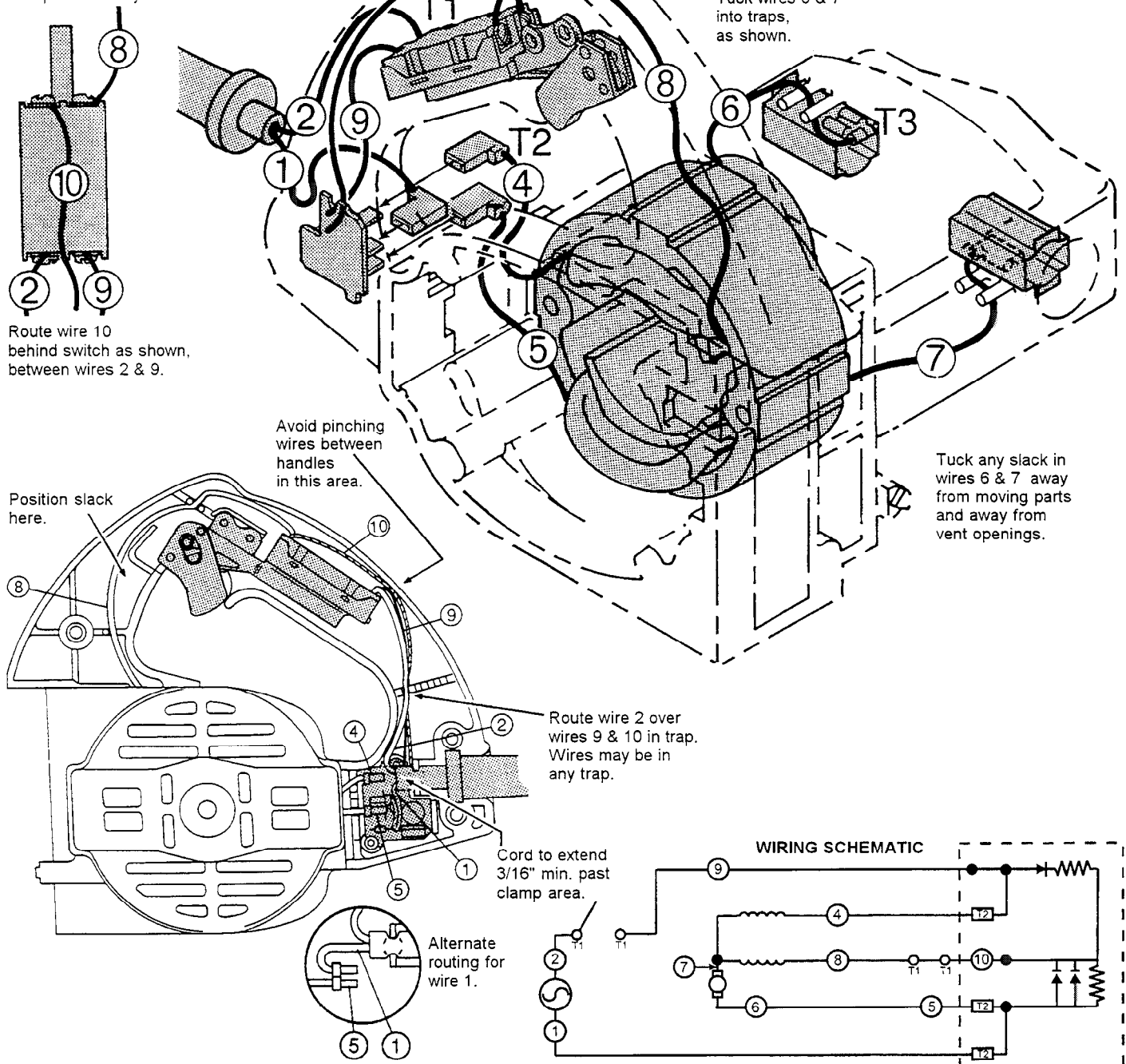

**WIRING SCHEMATIC**

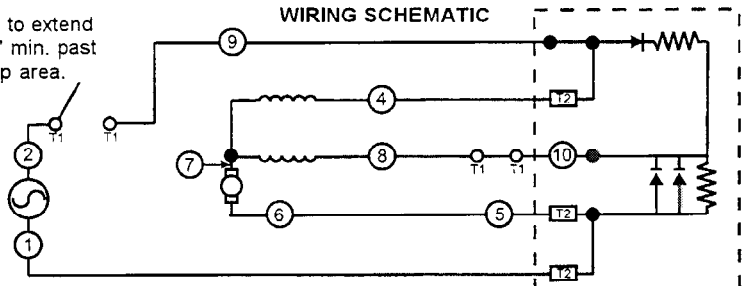

**WIRING SPECIFICATIONS**

Wire No.	Wire Color	Origin or Part No.	Gauge	Length	Terminals, Connectors and End Wire Preparation
1	White	Cord	16	2-1/4"	Strip 1/4" for T2.
2	Black	Cord	16	5"	Strip 3/16" for T1.
4	Black	Field	16	2-3/8"	Strip 1/4" for T2.
5	White	Field	16	4"	Strip 1/4" for T2.
6	White	Field	16	3-7/16"	Strip 3/16" for T3.
7	Black	Field	16	3-7/16"	Strip 3/16" for T3.
8	Yellow	Field	16	8-5/8"	Strip 3/16" for T1.
9	Black	Module	18	5"	Strip 3/16" for T1.
10	Red	Module	18	6-1/2"	Strip 3/16" for T1.

NOTE:  
All leads must be held to ± 1/8".  
All lead lengths are before stripping.

**TERMINAL DESCRIPTION**

Code	Part No.	Qty.
T1	23-74-0896	4
T2	23-74-1130	3
T3	23-74-0300	2

**BULK LEAD WIRE - BULLETIN 58-01-0003**